

## BOTTOM MOUNT INSTALLATION INSTRUCTIONS

1. BEFORE REMOVING YOUR BOARDS FROM YOUR TRAILER MEASURE THE DISTANCE FROM THE BACK OF ONE OF THE BOARDS TO THE FIRST BRACKET THAT SUPPORTS IT.
2. REMOVE THE OLD.
3. PLACE ONE OF THE NEW BOARDS ONTO THE SUPPORT BRACKET...SET THE DISTANCE FROM THE BACK OF THE BOARD TO THE FIRST SUPPORT BRACKET THE SAME MENTIONED IN STEP #1...POSITION INTO PLACE.
4. DRILL A SMALL 1/8" PILOT HOLE HALF WAY THROUGH THE NEW BOARD TO THE SUPPORT BRACKETS.
5. USE 1.5" COARSE-THREADED LAG SCREWS TO ATTACH THE BOARDS TO THE SUPPORT BRACKETS. DO NOT OVER-TIGHTEN THE SCREWS...(JUST SNUG THE SCREW DOWN TILL IT IS TIGHT)
6. ATTACH ALL BOARDS USING THE SAME PROCEDURE AS ABOVE.
7. PUT YOUR BOAT BACK ON YOUR TRAILER AND ENJOY YOUR NEW ULTIMATE BUNKBOARDS.

### IK-101 DRILL BIT KIT

1/8" DRILL BIT FOR PILOT HOLES

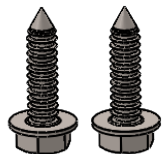

HEX-HEAD LAG SCREW



LOCK WASHERS

### IK-102 HARDWARE KITS

**ULTIMATE**  
BUNK BOARDS

5974 US HWY. 129 N. UNIT O  
PENDERGRASS GA. 30567

UBB-MOUNT STANDARD

INTL. JL

8-30-17

SCALE: 1:5

SHEET 1 OF 1